

X20SA1 V001...V005

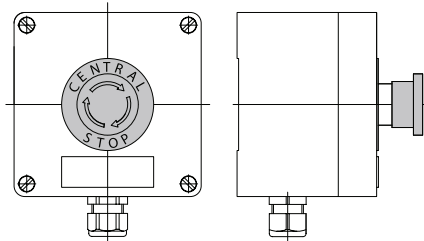

X20SA1 V006...V010

Text specification	??	Example
CENTRAL STOP	CS	X20SA1 V001/CS
EMERGENCY STOP	ES	X20SA1 V006/ES
EMERGENCY SWITCHING OFF	ESO	X20SA1 V001/ESO

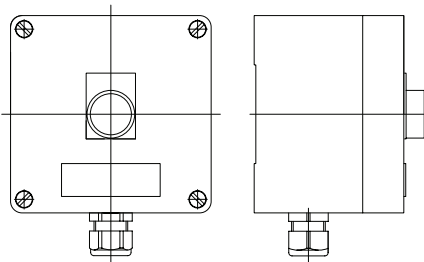

X20SA1 V011...V015

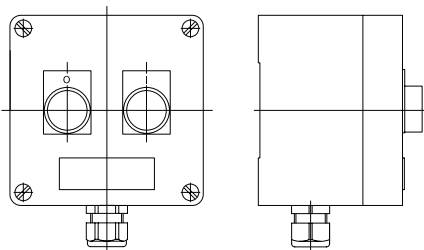

X20SA1 V017...V020

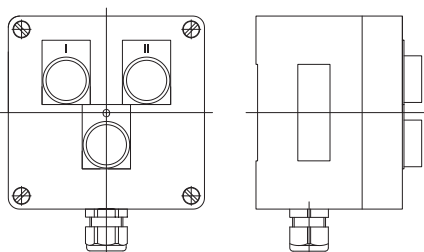

X20SA1 V105...V108

Type of protection	Ⓢ II 2G Ex db eb IIC T6 Gb Ⓢ II 2D Ex tb IIIC T85°C Db
Ingress protection	IP65
Material, dimensions	polyester, (w × h × d) 122 × 120 × 90 mm
Mounting holes / spacings	4 × ø 6,6 / 106 × 82 mm
Rated voltage and current	415 V, 10 A
Switching capacity	AC15: 240 V/3 A, DC13: 250 V/0,27 A
Connection	screw terminals, max. 2 × wire 2.5 mm ²
Cable gland	M20 (ø 7 – ø 12) mm

MUSHROOM UNDER-GLASS PUSH BUTTON		
Control head	red mushroom, turn to release	
Label text	see table (others to order)	
Weight	0,9 kg	
	Contacts	Order number
	1NO	X20SA1 V001/??
	1NC	X20SA1 V002/??
	1NO/1NC	X20SA1 V003/??
	2NC	X20SA1 V004/??
	2NO	X20SA1 V005/??

MUSHROOM PUSH BUTTON WITHOUT GLASS		
Control head	red mushroom, turn to release	
Label text	see table (others to order)	
Weight	0,9 kg	
	Contacts	Order number
	1NO	X20SA1 V006/??
	1NC	X20SA1 V007/??
	1NO/1NC	X20SA1 V008/??
	2NC	X20SA1 V009/??
	2NO	X20SA1 V010/??

PUSHBUTTON						
Control head	spring return, for colour see table					
Label text	no text (text to order)					
Weight	0,9 kg					
	Contacts	Order number				
	1NO	X20SA1 V011/??				
	1NC	X20SA1 V012/??				
	1NO/1NC	X20SA1 V013/??				
	2NC	X20SA1 V014/??				
	2NO	X20SA1 V015/??				
Fill in the colour according to the table instead of the question mark, e.g. X20SA1 V011/WH						
Colour:	green	white	red	yellow	black	blue
Code:	GN	WH	RD	YE	BK	BU

DOUBLE PUSHBUTTON						
Control head	spring return, for colour see table					
Label text	0, I (other texts to order)					
Weight	0,9 kg					
	Contacts button 0	Contacts button 1	Order number			
	1NC	1NO	X20SA1 V017/??			
	1NO	1NO	X20SA1 V018/??			
	1NC	1NC	X20SA1 V019/??			
	1NO/1NC	1NO/1NC	X20SA1 V020/??			
Fill in the colour according to the table instead of the question mark, e.g. X20SA1 V017/WH/GN						
Colour:	green	white	red	yellow	black	blue
Code:	GN	WH	RD	YE	BK	BU

TRIPLE PUSHBUTTON			
Control head	spring return, for colour see table		
Label text	0, I, II (other texts to order)		
Weight	0,9 kg		
	Button I – 1NO	Button II – 1NO	Order number
	green	green	white X20SA1 V105
			red X20SA1 V106
			red X20SA1 V107
	black	black	black X20SA1 V108

Other variants to order. Detailed technical data on demand – e-mail: obchod@generi.cz.

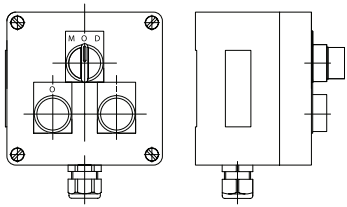

X20SA1 V120

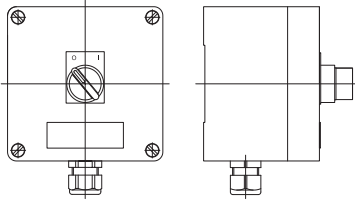

X20SA1 V027
X20SA1 V028

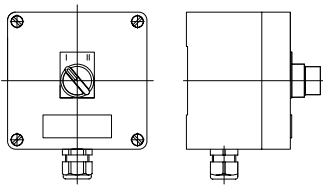

X20SA1 V029

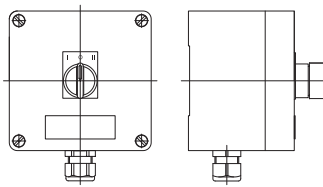

X20SA1 V030

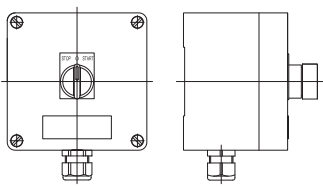

X20SA1 V031

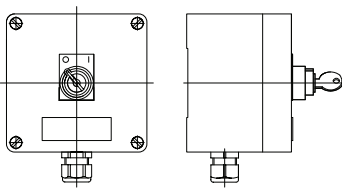

X20SA1 V032

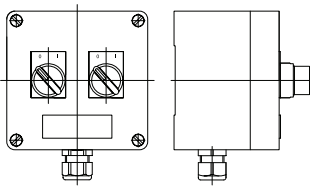

X20SA1 V033

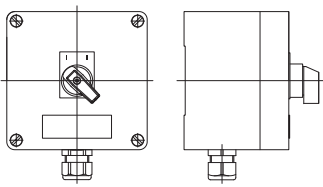

X20SA1 V034

DOUBLE PUSHBUTTON WITH SELECTOR SWITCH

Control head	Buttons – spring return, for colour see table Selector switch – rotary with fixed positions, black colour
Label text	O, I, M-O-D (other texts to order)
Weight	1,0 kg

Button 0	Button 1	Switch M - O - D	Order number
			X20SA1 V120/?/?

Fill in colours of the O and I buttons instead of the question mark, e.g. X20SA1 V120/BK/GN

Colour:	green	white	red	yellow	black	blue
Code:	GN	WH	RD	YE	BK	BU

TWO-POSITION / THREE-POSITION SELECTOR SWITCH

Control head	rotary with fixed position or spring return, black colour
Label text	see table
Weight	0,9 kg

				Order number
Single pole switch				X20SA1 V027
2-pole switch				X20SA1 V028
3-way switch				X20SA1 V029
3-position switch				X20SA1 V030
3-position switch, spring return to centre				X20SA1 V031
Single pole switch lockable				X20SA1 V032
Double switch				X20SA1 V033
4-way switch (intermediate switch)				X20SA1 V034

Other versions (label texts, cable glands, locking in a different position, padlocking, etc.) to order.

Other variants to order.

Detailed technical data on demand – e-mail: obchod@generi.cz.